



SUREMASTER-1650Micro

Large Format Roll Laminator



Large Format
Hot Roller Laminator

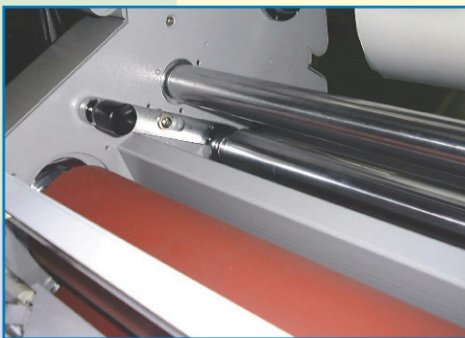
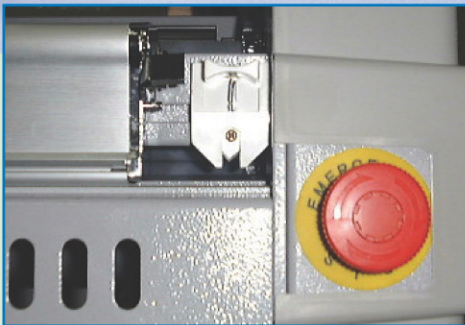

SUREMASTER-1650Micro

- ◆ Separator and rewinder for Micronex film
- ◆ Hot Lamination, Cold Lamination, Micronex Lamination, Mounting
- ◆ Enhancing the function of Feed Table
 - Easy to use for wide web
 - Installation of paper guide for media
 - Easy to use for wide media holder
- ◆ Independent temperature control of top and bottom roller
- ◆ Aerodynamic cooling system
- ◆ 9 different user's memory program
- ◆ Automatic power shut-off and stand-by system
- ◆ Easy removable mechanical Safety Cover



SUREMASTER-1650Micro

Roll Laminator

Standard Features

- ¥Designed for dual film core and stronger unwinder shaft
- ¥Speed Setting up to 3m/min
- ¥Pre-set 13mm Gap for FOAMBOARD® Mounting
- ¥Variable Pressure Control
- ¥No Special Power Supply Needed. Only Requires Standard Household Power Outlet

Superb laminating results on a wide range of standard laminating films from 25mic to 500mic, including PHOTONEX® soft touch film and CHROMONEX® hard touch film.

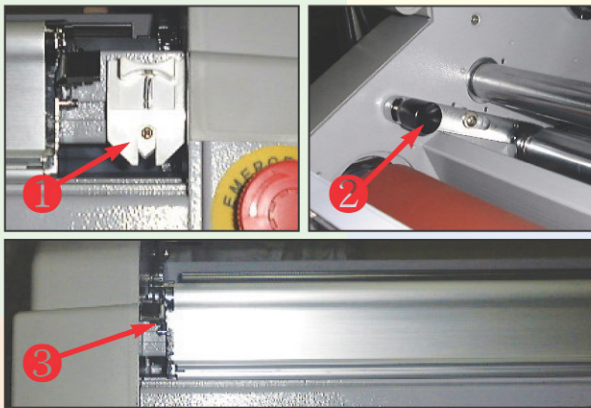

- ① Cross Cutter
- ② Stretch Bar Lever - Easy for Film Removable
- ③ Separator - Using for Micronex

Features include variable speed, temperature and pressure control, as well as LCD panel, pre-set functions, mounting

SUREMASTER Series are the perfect machines for wide range of service in a copy shop environment or in a copy center, graphic printing shop and photo shop. Ideal for laminating posters, inkjet prints, leaflets, maps wide photographs with superb results, and for truly professional mounting onto 13mm LAMIBOARD®.

Specifications

Model Name	SUREMASTER-1650Micro
Laminating Speed	3m/min
Laminating Width	1650mm
Laminating Films	25mic~500mic
Thickness of substrate(Paper)	80g/m ² ~ 350g/m ²
Thickness Mount	13mm
Power Requirements	AC 220V-240V, 50/60Hz
Power Consumption	3300W, 15A
Warm Up Time	25 minutes
Heating System	Heat Roller Internal Infrared Heater
Operating Temperature	150°C Max.
Speed Control	Key Pad
Temperature Control	Key Pad
Pressure Adjustment	Manual (lever, 5-preset)
Film Core	19-77Dual
Cooling System	Blower
Dimensions(WxLxH)	2000 x 820 x 1370mm
Type of Main Motor	DC W-Geard Motor /36V80
Type of Rewinder Motor	Link to Main Motor

Copyright GMP 2003. All rights reserved. Reproduction by any means of any image in this catalogue is prohibited without the prior written consent of GMP and its authorized agent

GMP reserves the right to after change specifications without prior notice.

- * Chromonex® : PP and PET composited Film
- * Photonex® : Heat Seal Laminating utilizing PVC material Film
- * Polynex® : Heat Seal Laminating utilizing OPP material Film
- * Micronex® : Heat Seal Laminating utilizing ultra thin dry overcoating Film